

MOTORIZED HEAVY DUTY SHADE WITH HOUSING AND SIDE TRACKS

Installation Instructions

1010

Tools Needed
Drill 3/8" Metal Drill Bit 1/4" Masonry Drill Bit Measuring Tape Pencil 4" Level Phillips #2 Driver Manual Screwdriver (Phillips)
Hardware Provided (per shade)
End Caps (Brackets) (2) Housing (1) Shade Fabric Tube (1) Side Rails (2) Deco Caps (6-8) Remote (1) Motor Clip (1)
Hardware Needed
5/16" X 4 1/2" Lag Screws or Appropriate (4 or more) 3/8" Flat Washers or Appropriate (4 per shade) 2 1/2" Drywall Screws (6-8)

Prepare Back of Housing



Starting at one at end of housing, make two mounting hole marks 1 1/4" in from end cap on your housing.



Using a 3/8" metal drill bit, drill the two mounting holes.

Repeat this process on other side of housing with other end cap.



Drill a third hole for motor wire at end of housing where power source will be (within 1 1/4" from end cap).

It is best to run motor wire through side or bottom of housing, be sure wire will not interfere with operation of the shade.

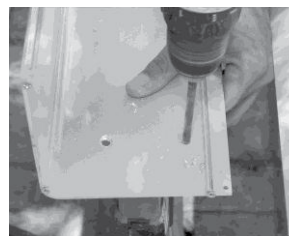

If drilling top, wire hole MUST be sealed to prevent water damage to motor.

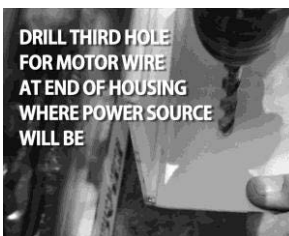

[Note: Top mount holes are on top of the housing, surface mount holes are on back of the housing.]

Pictures above demonstrate surface mount holes.]



SUN CONTROL
RETRACTABLE SHADES
America's Shade Experts

Toll Free 877-792-1775 | Fax 877-792-0031
swsuncontrolpro.com | sales@swsuncontrol.com

MOTORIZED HEAVY DUTY SHADE WITH HOUSING AND SIDE TRACKS

Installation Instructions

1010

Prepare Back of Housing *(continued)*

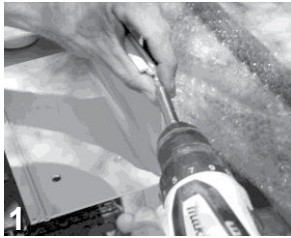

[STEPS 1-3]

Start at one end of housing and remove 3 screws attached to housing and set aside.

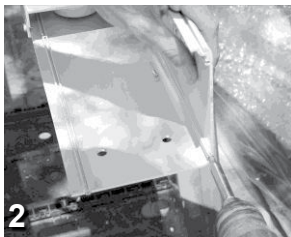

Repeat same process on other side of housing.

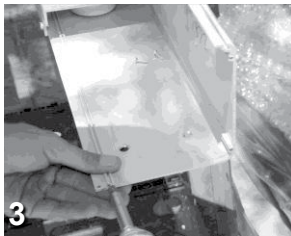

[STEPS 4-6]

Align gear bracket up to screw holes, *(holes you just removed screws from)*

Secure bracket using 3 screws you set aside with Phillips screwdriver.

(Arrows pointing to holes in bracket).

Repeat same process on opposite side with idler bracket.

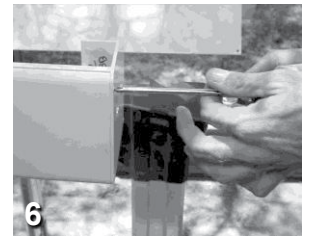
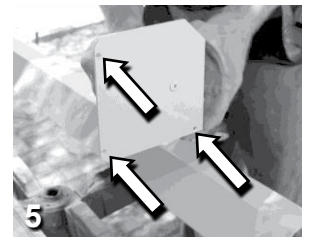
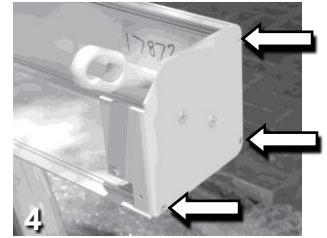

Hang Back of Housing - 2 Person Job



[STEPS 1-3]

Once you decide where your housing will hang, hold back of housing up to surface and starting on one side, drill starter holes into mounting surface and secure first lag screw and washer on top hole.



Make sure your housing is level. Repeat process on other side of housing.

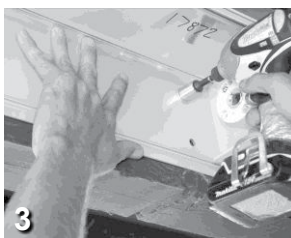

[STEPS 4-5]

Once housing is secure by itself, bolt your final bottom two lags and washers on each side.

Bolts must be installed in upper corner of box—keep away from the center of the box.



Remove hood screws on both sides of housing located underneath the brackets and set aside.



MOTORIZED HEAVY DUTY SHADE WITH HOUSING AND SIDE TRACKS

Installation Instructions

1010



Hang Back of Housing - 2 Person Job

Starting on one side, place side rail on flat surface directly underneath housing, making sure it is flush (#1).



Secure the top hole using an appropriate screw for your mounting surface (#2).



Making sure the side rail is level, secure the remaining screws (#3, #4).

Repeat this process on the other side (#5).

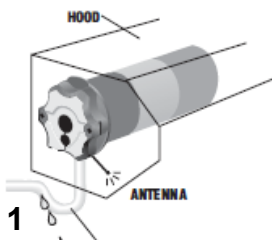

Hang Back of Housing - 2 Person Job

PLEASE NOTE: In order to avoid water penetration, form a "drip loop" with the power cable and use hood when required (#1).

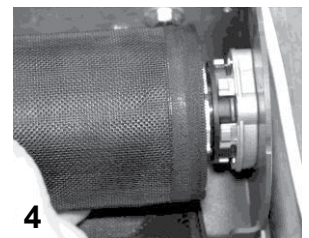

Remove motor clip from star bracket and set aside (#2).

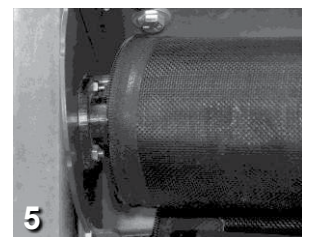

Remove bolt from cradle idler and place white bearing on round pin.

Make sure motor wire is placed in side channel (under yellow cap).

Before installing tube, first insert bottom slats of shade into side rails on both sides (#3).

Slide motor end of shade into star bracket (#4).

Slip round pin into idler and replace bolt in idler (#5-6).

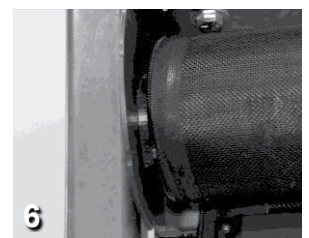

MOTORIZED HEAVY DUTY SHADE WITH HOUSING AND SIDE TRACKS

Installation Instructions

1010

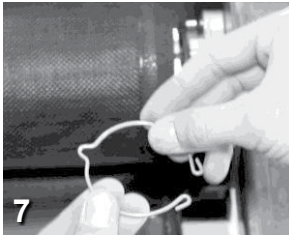

Hang Back of Housing - 2 Person Job *cont.*

Reinstall motor clip onto bracket, making sure mouth snaps in place over bracket and motor head (#7-9).

Feed motor wire through third hole in housing (#10).

Tie motor wire into electrical source, such as junction box (#11).

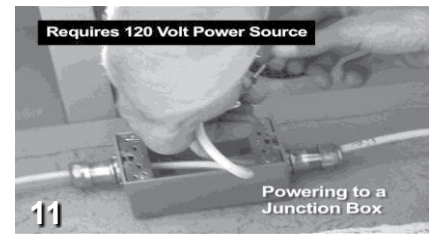
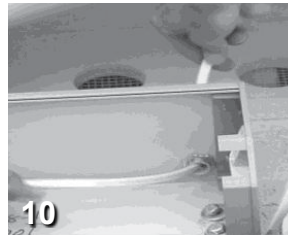
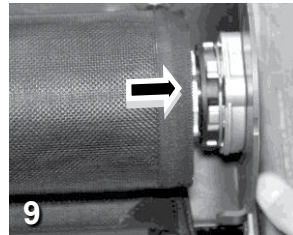
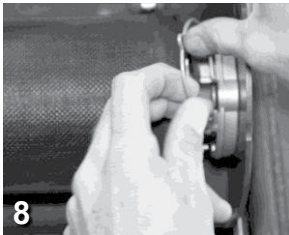

Test Shade

Run shade up and down a few times by pressing the up and down arrows on the provided remote to be sure there are no adjustments needed.



Install Deco-Caps

NOTE: Skip to step if side rails are a side mount.

Snap caps provided into mounting holes on side rails.



Install Front/Bottom Housing

Set housing into groove at top and bring down to set into place.

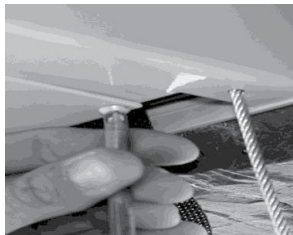

Install the two hood screws you put aside earlier onto bottom of front housing to secure, one on each side.



MOTORIZED HEAVY DUTY SHADE WITH HOUSING AND SIDE TRACKS

Installation Instructions

1010



Adjust Motor Limits

[NOTE: Motors come pre-programmed with short limits.]

To change the lower limit, send the motor to its current lower limit by pressing the down arrow.

Press both the up and down button at the same time until the motor jogs.

Adjust to your desired lower limit position and press the “my” button until the motor jogs.

This saves your lower limit. To change the upper limit, send the motor to its current upper limit.

Press both the up and down buttons at the same time until the motor jogs.

Adjust to your desired upper limit position and press the “my” button until the motor jogs. This saves your upper limit.



Confirm Limits

Send the shade to both the upper and lower limits.

The shade should roll up and down on cable guides and stop on its own at the programmed limit settings.

You're done!
Enjoy!